



Low Pressure Systems

1.877.247.5644

[www.airlogiccarwash.com](http://www.airlogiccarwash.com)

[airlogiclowpressure@gmail.com](mailto:airlogiclowpressure@gmail.com)

1621 N. Stone Ave.

Tucson, AZ 85705

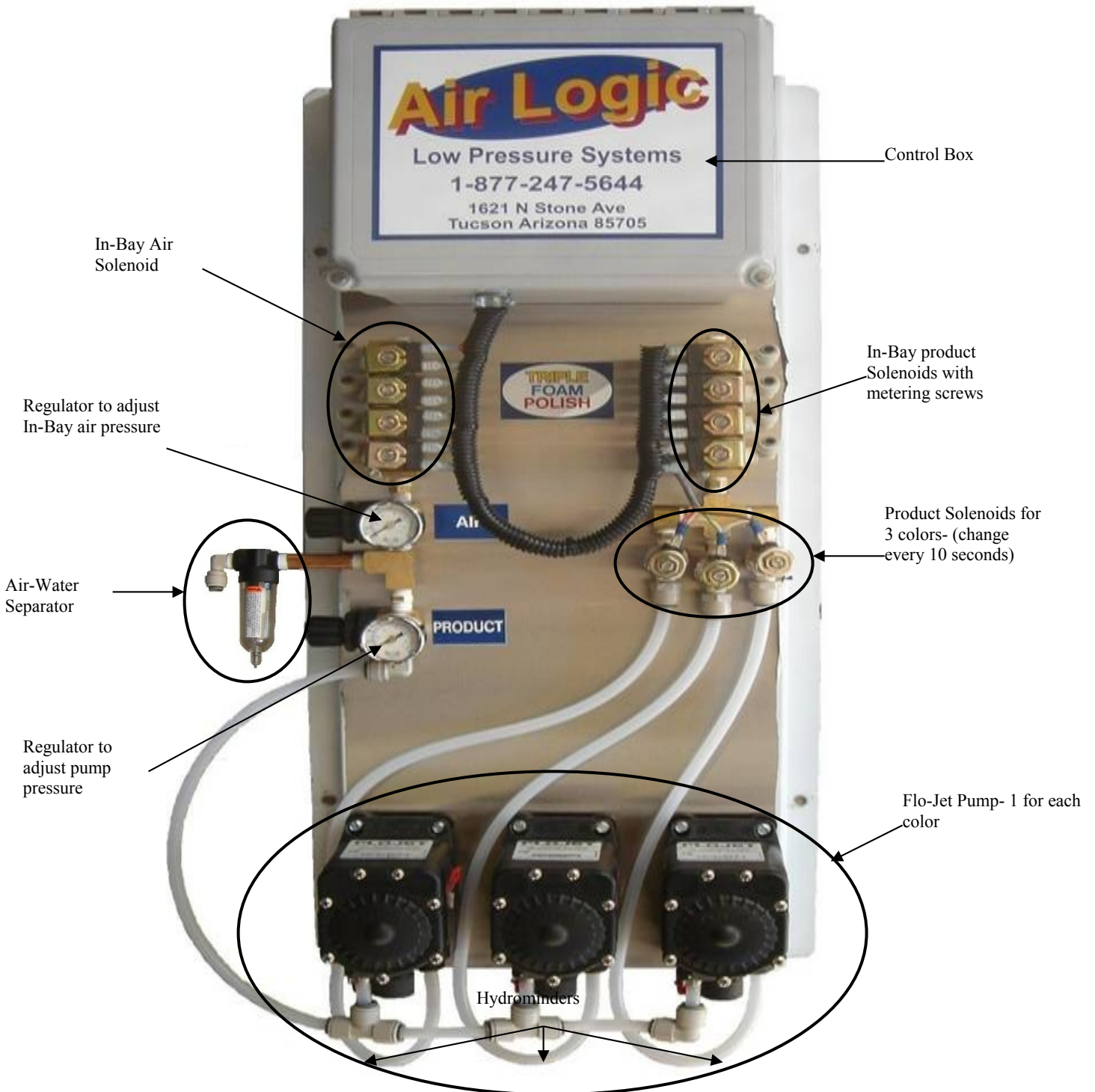

## 3- Pump Model Diagram



Product tanks

### **Instructions**

- Use extra Blue Foot Valves for pick up lines to Flo-Jet pumps or to 3 color product Solenoids for single pump units.
- Install Air-Water separator to Air Regulator
- Install Control Board and Tank Board to wall using proper hardware. (Remember Tank Board is fairly heavy when filled with product).
- Install main Air Line to Air Separator\* (120 PSI max).
  - \* For Single pump Triple Foam connect to on/off Solenoid on Control Box
- Install water supply to Hydrominder manifold (40 PSI recommended).

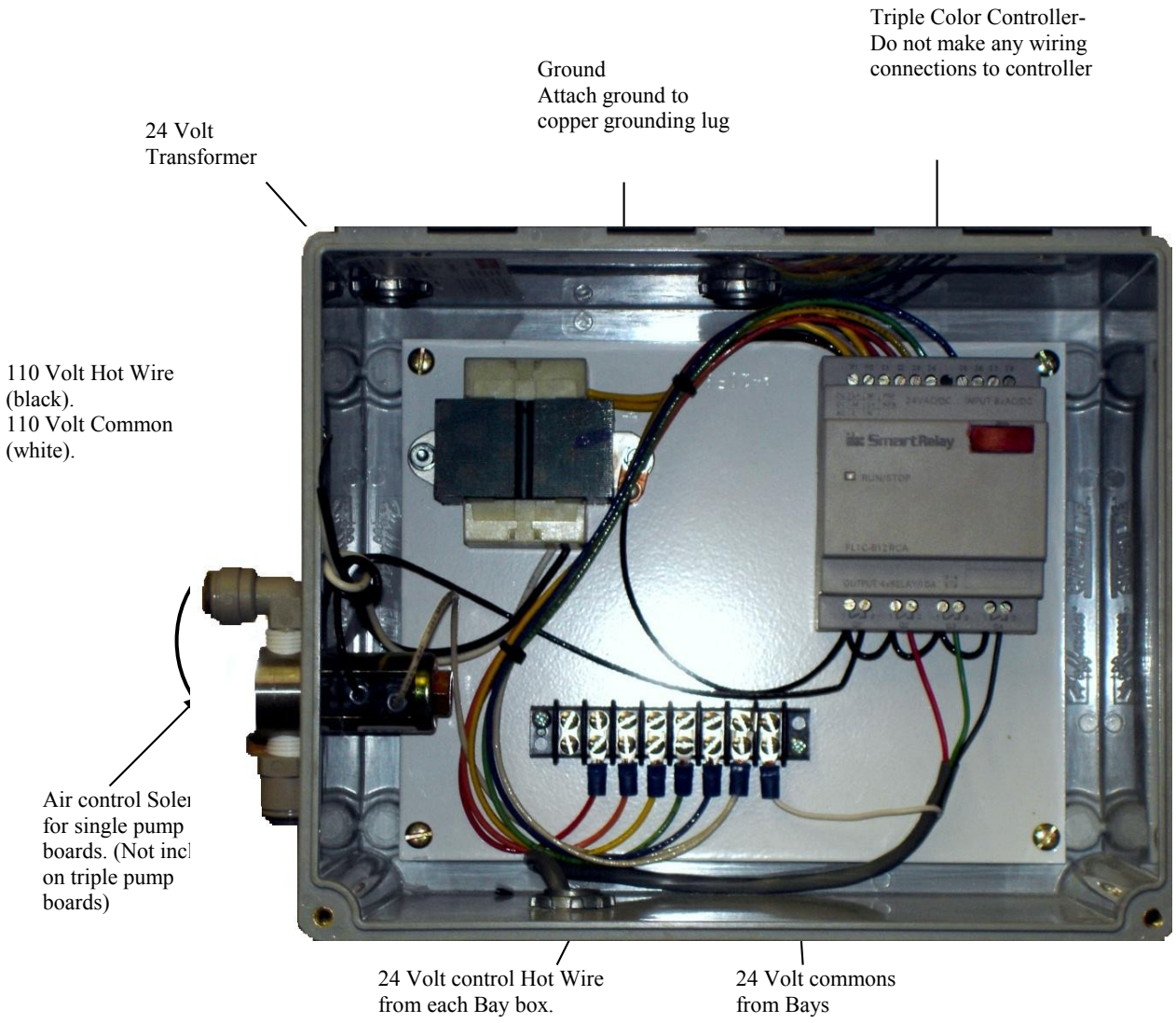

# CONTROL BOX DIAGRAM

1. Connect 110 Volts to transformer leads in Control Box. Connect ground to lug. (Do not connect 110 volts to any other location in Control Box. 110 volts only activates 24 volt transformers). Be sure to use appropriate wire connectors.
2. Connect one 24 volt control wire and one common from each Bay to the wiring strip. All commons connect to the Right end of the strip. All Hot 24 volt wires connect to the corresponding positions starting with Bay 1 on the left side.

## **INSTALL IN-BAY EQUIPMENT**

Connect the ¼ poly tubing foam bays to the solenoid blocks. (One Air and one product tube per Bay). Solenoids are numbered top to bottom. Bay one is at the top.

## **START-UP PROCEDURE**

Fill product reservoirs with Solution. Note- Since tanks are small be sure to get proper mixture for startup and adjustment- turn on 110 volts to Control Box.

- Set Air Regulator to 25
- Set Pump Regulator to 40
- Open metering screws or Product Solenoids 1 ½ turns
- Make adjustments as necessary. Some units are running pump pressures up to 60 PSI and Air at 40 to 45 depending on product performance.